

METRIC

TECHNICAL DATA SHEET

Stainless hollow sections

| Austenitic

| Ferritic

| Duplex

About Stalatube

Stalatube is known worldwide as a leading provider of stainless steel solutions and a manufacturer of highly developed stainless steel hollow sections, profiles and components. With a global presence, in-depth material expertise and the world's widest product portfolio in stainless square and rectangular hollow sections, we help customers connect the right solution with their application or project - in even the most complex of cases. Our customizable, environmentally conscious solutions are here to build a better future. By co-operating with customers and investing in R&D, we believe anything can be achieved.

During over 45 years of pioneer work in the industry, we have built an international distribution network covering all continents and over 50 countries. Our head office and main production are in Finland, sales offices in the Netherlands, Poland, USA and India, and a new production facility for further processed products is soon to open in Poland. To assist you in being the best, we provide world-class stainless steel know-how, cutting-edge technology and a full range of professional services.

Stalatube – Use our strength!

Services

Technical consultation

Our experienced staff have extensive know-how on all matters concerning stainless steel. If you have any doubts or questions about stainless steel materials, processing or welding, we are always willing to assist. Not only in theory, but also in practice, hands-on at your plant. Don't hesitate to contact us!



Testing and certification

Get precise documentation, certifications, test reports or other statements for needed purpose. The traceability of our products is always accurate.



Surface enhancement

Surface finish is an essential part of the outlook, durability and functionality of a stainless steel structure. It is even possible to make surfaces hygienic where necessary.



Polishing	Ra [µm]
Grit 180	1.5 - 1.9
Grit 220/240	1.0 - 1.4
Grit 320	0.6 - 0.9
Polished tubes are single-packed: for dimensions ≤ 60 x 60 packing in plastic sleeve and for > 60 x 60 in plastic foil.	
Bundles are packed with plastic foil, plastic bands and corner protections.	
Pickling	
Dip pickling	
Bundles are packed with plastic foil, plastic bands and corner protections	

OTHER OPTIONAL SERVICES

Corner polishing and special surfaces by request

Tailoring

Tailoring adds value to stainless products. Products can be cut to any desired length, perforated or laser cut. Smart components can be tailored to meet our customers' needs.



Stalafit

Our Stalafit service allows you to order hollow sections, I-beams and profiles with tailored outer dimensions at intervals of one millimeter. Possible sizes can be checked with our sales personnel or with Stalafit PRO.



Stalafit PRO

To professionally design stainless structures in accordance with Eurocode, we have created the design application Stalafit PRO, which can be found from stalafit.stalutube.com or from mobile markets.

TOLERANCES	
Cut to length service	4-18 m, tolerance -0/+20 mm
Precise cutting	20-9000 mm, tolerance ± 1 mm ≥ 9000 mm, tolerance depends on the length
Angle cutting	30-90°, tolerance $\pm 1^\circ$
Laser cutting	Tolerance ± 0.5 mm

Standard cut with laser (if corner without gap is required, please specify separately)

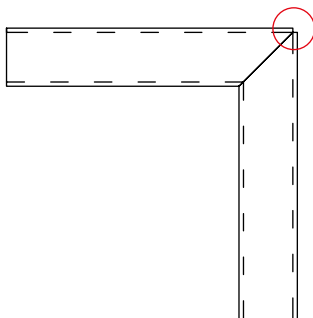

Cut with saw

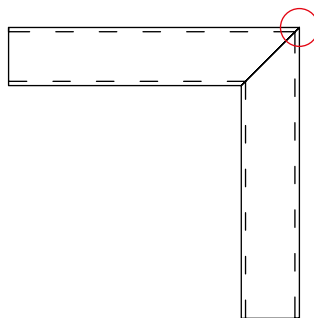

Smart logistics

We guarantee short delivery times and accurate deliveries. Products are delivered in prime condition and ready for installation with each package clearly identified by specification and certification.



OTHER OPTIONAL SERVICES

Marking with stickers available by request.

Steel grades - chemical and mechanical properties

CHEMICAL COMPOSITION (EN 10088-2 AND EN 10088-4)											
(% by mass, maximum values unless indicated otherwise)											
Austenitic											
EN	C	Si	Mn	P	S	N	Cr	Mo	Ni	Others	PRE
1.4301	0.070	1.00	2.00	0.045	0.015	0.10	17.5-19.5		8.0-10.5		18
1.4307	0.030	1.00	2.00	0.045	0.015	0.10	17.5-19.5		8.0-10.5		18
1.4404	0.030	1.00	2.00	0.045	0.015	0.10	16.5-18.5	2.0-2.50	10.0-13.0		24
1.4571	0.080	1.00	2.00	0.045	0.015		16.5-18.5	2.0-2.50	10.5-13.5	Ti 5xC-0.70	24
Ferritic											
EN	C	Si	Mn	P	S	N	Cr	Mo	Ni	Others	PRE
1.4003	0.030	1.00	1.50	0.040	0.015	0.030	10.5-12.5		0.30-1.00		12
Lean Duplex and Duplex											
EN	C	Si	Mn	P	S	N	Cr	Mo	Ni	Others	PRE
1.4062 ¹⁾	0.030	1.00	2.00	0.040	0.010	0.16-0.28	21.5-24.0	0.45	1.00-2.90		26
1.4162	0.040	1.00	4.0-6.0	0.040	0.015	0.20-0.25	21.0-22.0	0.10-0.80	1.35-1.70	Cu 0.10-0.80	26
1.4362	0.030	1.00	2.0	0.035	0.015	0.05-0.20	22.0-24.0	0.10-0.60	3.5-5.5	Cu 0.10-0.60	28
1.4462	0.030	1.00	2.0	0.035	0.015	0.10-0.22	21.0-23.0	2.50-3.50	4.5-6.5		35

1) Fulfills the standard EN 10088-2

MECHANICAL PROPERTIES, ROLL FORMED HOLLOW SECTIONS				
STANDARD STRENGTH CLASS				
Fulfills the standards EN 10088-2 and EN 10088-4				
Measured from coil, minimum values unless indicated otherwise				
Austenitic				
EN	0.2 % - proof strength Rp0.2 MPa	Tensile strength Rm MPa	Elongation A* %	
1.4301	210	520-720	45	
1.4307	200	520-700	45	
1.4404	220	530-680	40	
1.4571	220	540-690	40	
Ferritic				
EN	0.2 % - proof strength Rp0.2 MPa	Tensile strength Rm MPa	Elongation A* %	
1.4003	320	450-650	20	
Lean Duplex and Duplex				
EN	0.2 % - proof strength Rp0.2 MPa	Tensile strength Rm MPa	Elongation A* %	
1.4062	480	680-900	20	1)
1.4162	480	680-900	20	
1.4362	500	690	25	2)
1.4462	460	700-950	25	

1) Fulfills the standard EN 10088-2

2) EDX2304

* A80 when $T < 3$ mm, A5 when $T \geq 3$ mm

We reserve the right to changes. Stalutube takes no responsibility for any error in numerical information that might appear in this brochure.

MECHANICAL PROPERTIES, ROLL FORMED HOLLOW SECTIONS			
ENHANCED STRENGTH CLASS			
Measured from tube, minimum values			
Austenitic			
Available in steel grades 1.4301, 1.4307, 1.4404 and 1.4571			
Tube	0.2 % - proof strength Rp0.2 MPa	Tensile strength Rm MPa	Elongation A5 %
Stala 350 ¹⁾	350	600	30
Ferritic			
Available in steel grade 1.4003			
Tube	0.2 % - proof strength Rp0.2 MPa	Tensile strength Rm MPa	Elongation A5 %
Stala 400F ²⁾	400	450	10
Lean Duplex			
Available in steel grades 1.4062 and 1.4162			
Tube	0.2 % - proof strength Rp0.2 MPa	Tensile strength Rm MPa	Elongation A5 %
Stala 630D ³⁾	630	750	20

1) Available for dimensions up to 100 x 100 x 6 / 120 x 80 x 6 mm, 2) Available for dimensions up to 100 x 100 x 5 / 120 x 80 x 5 mm, 3) Available for dimensions up to 100 x 100 x 3 / 120 x 80 x 3 mm

MECHANICAL PROPERTIES, PRESS BRAKED HOLLOW SECTIONS (STALARGO)				
Fulfills the standards EN 10088-2 and EN 10088-4				
Measured from coil or plate, minimum values unless indicated otherwise				
Austenitic				
EN	0.2 % - proof strength Rp0.2 MPa	Tensile strength Rm MPa	Elongation A5 %	
1.4301	210	520-720	45	
1.4307	200	500-700	45	
1.4404	220	520-680	40	
1.4571	220	520-690	40	
Lean Duplex and Duplex				
EN	0.2 % - proof strength Rp0.2 MPa	Tensile strength Rm MPa	Elongation A5 %	
1.4062	450	650-900	30	1)
1.4162	450	650-900	30	
1.4362	420	630	25	2)
1.4462	460	640-950	25	

1) Fulfills the standard EN 10088-2
2) EDX2304

Roll formed hollow sections

Austenitic EN 1.4301, 1.4307, 1.4404, 1.4571

DELIVERY CONDITION

Forming	Cold formed (roll formed)
Welding process	TIG/Plasma, Laser or HF
Weld condition	External weld bead removed

TUBE MARKING

Ink-jet marking on tube	Stalutube Oy made in Finland, steel grade, dimensions, coil number, production week/year, welding operator
Bundle tag	Dimensions, steel grade, surface condition, bundle size, batch id, coil number, bundle number

BUNDLE PACKING

Plastic bands
Plastic foil

SURFACE CONDITION

Brushed (Stalazzo), when tube dimension is $\leq 100 \times 100 \times 6$ mm
As welded (unpol), when tube dimension is $> 100 \times 100 \times 6$ mm

SQUARE		WEIGHT [KG/M]									
H x B [mm]		1.2	1.5	2.0	3.0	4.0	5.0	6.0	8.0	10.0	12.0
20	20	0.729	0.901	1.176							
25	25	0.921	1.140	1.495							
30	30	1.112	1.379	1.814	2.645						
32	32	1.189	1.475	1.941	2.837						
35	35	1.304	1.618	2.133	3.124						
38	38	1.418	1.762	2.324	3.411						
40	40	1.495	1.858	2.452	3.602						
45	45		2.097	2.771	4.081						
50	50		2.336	3.090	4.559	5.979	7.349				
60	60		2.814	3.728	5.516	7.255	8.943	10.582			
70	70			4.366	6.473	8.531	10.538	12.496			
75	75			4.685	6.952	9.169	11.336	13.453			
80	80			5.004	7.430	9.807	12.133	14.410			
90	90			5.641	8.387	11.083	13.728	16.324			
100	100			6.279	9.344	12.359	15.323	18.237	23.916		
120	120				11.258	14.910	18.513	22.065	29.020	35.774	
140	140				13.172	17.462	21.703	25.893	34.123		
150	150				14.129	18.738	23.298	27.807	36.675	45.343	
200	200				18.913	25.118	31.272	37.376	49.434	61.292	72.950
220	220					27.670	34.462	41.204	54.538	67.672	80.605
250	250						39.247	46.946	62.194	77.241	92.089
300	300						47.221	56.515	74.953	93.190	111.227

Maximum thickness for steel grade 1.4571 is 6 mm.

TOLERANCES (ACCORDING TO EN 10219-2)

Characteristic	Tolerance	
Outside dimensions, B and H	B, H < 100 mm: $\pm 1\%$, min ± 0.5 mm 100 mm \leq B, H \leq 200 mm: $\pm 0.8\%$ B, H > 200 mm: $\pm 0.6\%$	
Concavity / Convexity (X^1/X^2)	Max. 0.8 % with a minimum of 0.5 mm	
Wall thickness, T	$\pm 10\%$, when $T \leq 5$ mm ± 0.5 mm, when $T > 5$ mm	
Squareness of sides	$90^\circ \pm 1^\circ$	
External corner profile, C ₁ , C ₂ or R	B+H \leq 200 mm and $T \leq 3$ mm: Max 1.5T B+H \leq 200 mm and $T > 3$ mm: 1.6T – 2.4T B+H > 200 mm and $T \leq 4$ mm: 2T – 3T B+H > 200 mm and $T > 4$ mm: 1.6T – 2.4T	1)
Length, L	Standard length 6 m, tolerance 0/+20 mm	1)
Straightness	0.15 % of total length	
Twist	2 mm + 0.5 mm/m	

1) Exception from standard

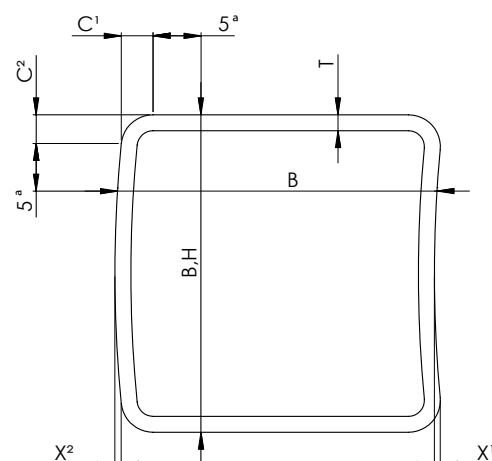

^a This dimension is maximum when measuring B or H and minimum when measuring T

RECTANGULAR		WEIGHT [KG/M]									
H x B [mm]		1.2	1.5	2.0	3.0	4.0	5.0	6.0	8.0	10.0	12.0
30	20	0.921	1.140	1.495							
35	25	1.112	1.379	1.814	2.645						
40	10	0.921	1.140	1.495							
40	20	1.112	1.379	1.814	2.645						
40	25	1.208	1.499	1.973	2.885						
40	30	1.304	1.618	2.133	3.124						
50	10	1.112	1.379	1.814							
50	20	1.304	1.618	2.133	3.124						
50	25	1.399	1.738	2.292	3.363						
50	30	1.495	1.858	2.452	3.602						
50	40		2.097	2.771	4.081						
60	10		1.618	2.133							
60	20		1.858	2.452	3.602						
60	30		2.097	2.771	4.081						
60	40		2.336	3.090	4.559	5.979					
70	50		2.814	3.728	5.516	7.255	8.943				
80	10		2.097	2.771							
80	20		2.336	3.090	4.559						
80	30		2.575	3.409	5.038						
80	40		2.814	3.728	5.516	7.255	8.943				
80	50			4.047	5.995	7.893	9.741				
80	60			4.366	6.473	8.531	10.538				
100	20		2.814	3.728							
100	30		3.054	4.047	5.995						
100	40			4.366	6.473	8.531	10.538				
100	50			4.685	6.952	9.169	11.336	13.453			
100	60			5.004	7.430	9.807	12.133	14.410			
100	80			5.641	8.387	11.083	13.728	16.324			
120	40			5.004	7.430	9.807					
120	60			5.641	8.387	11.083	13.728	16.324			
120	80			6.279	9.344	12.359	15.323	18.237			
120	100				10.301	13.635	16.918	20.151			
140	80				10.301	13.635	16.918	20.151			
150	50				9.344	12.359	15.323	18.237			
150	100				11.736	15.548	19.310	23.022	30.296	37.369	
160	80				11.258	14.910	18.513	22.065			
200	100				14.129	18.738	23.298	27.807	36.675	45.343	
250	100				16.521	21.928	27.285	32.592	43.055	53.318	
250	150				18.913	25.118	31.272	37.376	49.434	61.292	72.950
300	100				18.913	25.118	31.272	37.376	49.434	61.292	
300	200						39.247	46.946	62.194	77.241	92.089
400	200						47.221	56.515	74.953	93.190	111.227

Other dimensions may also be possible on request. Maximum thickness for steel grade 1.4571 is 6 mm.

ENHANCED
STRENGTH CLASS
Stala350
See Mechanical
Properties page 5

Also available as



See more information
on page 3

Ferritic EN 1.4003

DELIVERY CONDITION

Forming	Cold formed (roll formed)
Welding process	Laser or HF
Weld condition	External weld bead removed
Surface condition	As welded (unpol)

SQUARE WEIGHT [KG/M]

H x B [mm]		1.5	2.0	2.5	3.0	4.0	5.0
20	20	0.810					
25	25	1.041	1.337				
30	30	1.272	1.645	1.993	2.316		
35	35	1.503	1.953	2.378	2.778		
38	38	1.642	2.138	2.609	3.055		
40	40	1.734	2.261	2.763	3.240	4.117	
50	50	2.196	2.877	3.533	4.164	5.349	
60	60		3.493	4.303	5.088	6.581	7.973
70	70		4.109	5.073	6.012	7.813	9.513
75	75		4.417	5.458	6.474	8.429	10.283
80	80		4.725	5.843	6.936	9.045	11.053
100	100				8.784	11.509	14.133
120	120					13.973	17.213

RECTANGULAR WEIGHT [KG/M]

H x B [mm]		1.5	2.0	2.5	3.0	4.0	5.0
30	20	1.041	1.337				
40	20	1.272	1.645				
40	25	1.388	1.799				
40	30	1.503	1.953	2.378	2.778		
50	20	1.503	1.953				
50	30	1.734	2.261	2.763	3.240		
50	40	1.965	2.569	3.148	3.702		
60	20	1.734	2.261				
60	30	1.965	2.569	3.148	3.702		
60	40	2.196	2.877	3.533	4.164	5.349	
60	50		3.185	3.918	4.626	5.965	
70	50		3.493	4.303	5.088	6.581	
80	40		3.493	4.303	5.088	6.581	
80	50		3.801	4.688	5.550	7.197	
80	60		4.109	5.073	6.012	7.813	9.513
100	40		4.109	5.073	6.012	7.813	
100	50		4.417	5.458	6.474	8.429	
100	60		4.725	5.843	6.936	9.045	11.053
100	80				7.860	10.277	12.593
120	40				6.936	9.045	
120	60				7.860	10.277	12.593
120	80				8.784	11.509	14.133
140	80					12.741	15.673
150	100					14.589	17.983

TUBE MARKING

Ink-jet marking on tube	Stalalube Oy made in Finland, steel grade, dimensions, coil number, production week/year, welding operator
Bundle tag	Dimensions, steel grade, surface condition, bundle size, batch id, coil number, bundle number

BUNDLE PACKING

Plastic bands

TOLERANCES (ACCORDING TO EN 10219-2)

Characteristic	Tolerance	
Outside dimensions, B and H	B, H < 100 mm: $\pm 1\%$, min ± 0.5 mm B, H ≥ 100 mm: $\pm 0.8\%$	
Concavity / Convexity	Max. 0.8 % with minimum of 0.5 mm	
Wall thickness, T	$\pm 10\%$	
Squareness of side	$90^\circ \pm 1^\circ$	
External corner profile (C1, C2 or R)	1.6T - 2.4T	
Length	Standard length 6 m, tolerance 0/+20 mm	¹⁾
Straightness	0.15 % of total length	
Twist	2 mm + 0.5 mm/m	

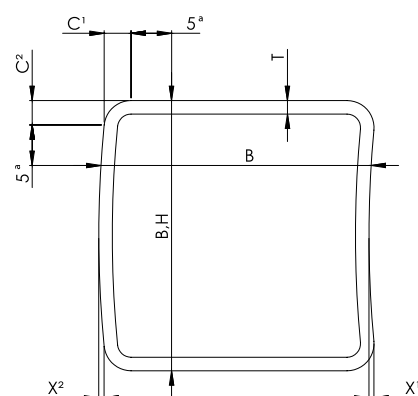
¹⁾ Exception from standard

^a This dimension is maximum when measuring B or H and minimum when measuring T

ENHANCED
STRENGTH CLASS

**Stala
400F**

See more information
on page 5

Also available as



See more information
on page 3

Lean Duplex and Duplex EN 1.4062, 1.4162, 1.4362, 1.4462

DELIVERY CONDITION

Forming	Cold formed (roll formed)
Welding process	TIG/Plasma, Laser or HF
Weld condition	External weld bead removed

TUBE MARKING

Ink-jet marking on tube	Stalutube Oy made in Finland, steel grade, dimensions, coil number, production week/year, welding operator
Bundle tag	Dimensions, steel grade, surface condition, bundle size, batch id, coil number, bundle number

All dimensions are available in steel grade 1.4162. Maximum thickness for steel grade 1.4062 is 5 mm. Steel grades 1.4362 and 1.4462 are possible for thickness ≥ 3 mm and B, H ≥ 60 mm.

SQUARE		WEIGHT [KG/M]							
H x B [mm]		1.5	2.0	2.5	3.0	4.0	5.0	6.0	8.0
25	25	1.055							
30	30	1.289	1.667						
32	32	1.382	1.792						
35	35	1.523	1.979						
38	38	1.663	2.166						
40	40	1.757	2.291	2.799					
50	50	2.225	2.915	3.579					
60	60	2.693	3.539	4.359	5.154	6.667			
70	70		4.163	5.139	6.090	7.915			
75	75		4.475	5.529	6.558	8.539			
80	80		4.787	5.919	7.026	9.163	11.197		
100	100			7.479	8.898	11.659	14.317	16.872	
120	120				10.770	14.155	17.437	20.616	
150	150				13.578	17.899	22.117	26.232	
200	200					24.139	29.917	35.592	46.635
250	250						37.717	44.952	59.115
300	300						45.517	54.312	71.595

RECTANGULAR		WEIGHT [KG/M]							
H x B [mm]		1.5	2.0	2.5	3.0	4.0	5.0	6.0	8.0
30	20	1.055							
40	20	1.289	1.667						
40	30	1.523	1.979						
50	20	1.523	1.979						
50	25	1.640	2.135						
50	30	1.757	2.291						
50	40	1.991	2.603						
60	20	1.757	2.291						
60	30	1.991	2.603						
60	40	2.225	2.915	3.579					
70	50	2.693	3.539	4.359	5.154				
80	40	2.693	3.539	4.359	5.154	6.667			
80	60		4.163	5.139	6.090	7.915			
100	40		4.163	5.139	6.090	7.915			
100	50		4.475	5.529	6.558	8.539			
100	60		4.787	5.919	7.026	9.163			
120	40		4.787	5.919	7.026	9.163			
150	100				11.238	14.779	18.217	21.552	
200	100				13.578	17.899	22.117	26.232	
250	150				18.258	24.139	29.917	35.592	
300	100					24.139	29.917	35.592	
300	200					30.379	37.717	44.952	59.115
400	200						45.517	54.312	71.595

SURFACE CONDITION

Brushed (Stalazzo), when tube dimension is $\leq 100 \times 100 \times 6$ mm
As welded (unpol), when tube dimension is $> 100 \times 100 \times 6$ mm

BUNDLE PACKING

Plastic bands
Plastic foil

TOLERANCES (ACCORDING TO EN 10219-2)

Characteristic	Tolerance	
Outside dimensions, B and H	B, H < 100 mm: ± 1 %, min ± 0.5 mm B, H ≥ 100 mm: ± 0.8 %	1)
Concavity / Convexity (X^1/X^2)	Max. 0.8 % with minimum of 0.5 mm	
Wall thickness, T	± 10 %	
Squareness of side	$90^\circ \pm 1^\circ$	
External corner profile, C1, C2 or R	B+H ≤ 200 mm: 1.6T – 2.4T B+H > 200 mm and T ≤ 4 mm: 2.0T – 3.0T B+H > 200 mm and T > 4 mm: 1.6T – 2.4T	1)
Length	Standard length 6 m, tolerance 0/+20 mm	1)
Straightness	0.15 % of total length	
Twist	2 mm + 0.5 mm/m	

1) Exception from standard

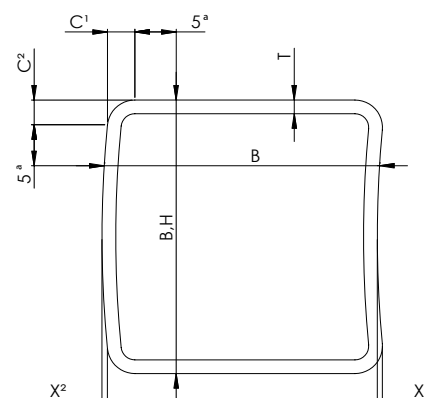

^a This dimension is maximum when measuring B or H and minimum when measuring T

ENHANCED
STRENGTH CLASS

**Stala
630D**

See more information
on page 5

Also available as



See more information
on page 3

Stalargo press brake hollow sections

EN 1.4301, 1.4307, 1.4404, 1.4571, 1.4062, 1.4162, 1.4362, 1.4462

Press brake hollow sections in Duplex grades are available for dimensions with T=6-12 mm, B and H 150-500 mm

DELIVERY CONDITION	
Forming	Press braked, made of two U or J profiles
Welding process	Laser or MAG
Surface condition	As welded (unpol) and pickled

BUNDLE PACKING	
Plastic bands	
Corner protection	

TUBE MARKING	
Marking on tube	Coil or plate number
Bundle tag	Dimensions, steel grade, surface condition, bundle size, batch id, coil or plate number, bundle number

SQUARE		WEIGHT [KG/M]								
H x B [mm]		3	4	5	6	8	10	12	15	16
120	120	10.85	14.23	17.49	20.64					
140	140	12.74	16.76	20.65	24.43	31.63				
150	150	13.69	18.02	22.23	26.32	34.16	41.52	48.42		
160	160	14.64	19.28	23.81	28.22	36.69	44.68	52.21		
180	180	16.54	21.81	26.97	32.01	41.74	51.00	59.79		
200	200	18.43	24.34	30.13	35.80	46.80	57.32	67.38	81.58	86.07
250	250		30.66	38.03	45.28	59.44	73.12	86.34	105.28	111.35
300	300		36.98	45.93	54.76	72.08	88.92	105.30	128.98	136.63
400	400				73.72	97.36	120.52	143.22	176.38	187.19
500	500				92.68	122.64	152.12	181.14	223.78	237.75
600	600				111.64	147.92	183.72			
800	800					198.48	246.92			
1000	1000						310.12			

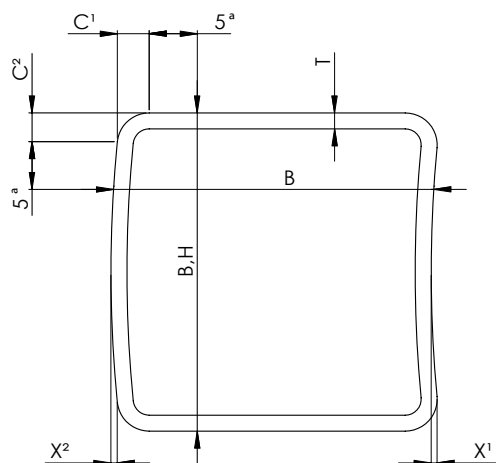

^a This dimension is maximum when measuring B or H and minimum when measuring T

Also available as



See more information on page 3

RECTANGULAR		WEIGHT [KG/M]								
H x B [mm]		3	4	5	6	8	10	12	15	16
150	50	8.95	11.70	14.33	16.84					
150	80	10.37	13.60	16.70	19.69					
160	100	11.80	15.49	19.07	22.53	29.10				
180	100	12.74	16.76	20.65	24.43	31.63				
200	100	13.69	18.02	22.23	26.32	34.16				
250	150	18.43	24.34	30.13	35.80	46.80	57.32	67.38		
300	100	18.43	24.34	30.13	35.80	46.80				
300	200		30.66	38.03	45.28	59.44	73.12	86.34	105.28	111.35
350	150		30.66	38.03	45.28	59.44	73.12	86.34		
350	250		36.98	45.93	54.76	72.08	88.92	105.30	128.98	136.63
400	100		30.66	38.03	45.28	59.44				
400	300				64.24	84.72	104.72	124.26	152.68	161.91
450	150				54.76	72.08	88.92	105.30		
500	100				54.76	72.08				
500	200				64.24	84.72	104.72	124.26	152.68	161.91
500	300				73.72	97.36	120.52	143.22	176.38	187.19
500	400				83.20	110.00	136.32	162.18	200.08	212.47
600	200				73.72	97.36	120.52			
600	400				92.68	122.64	152.12			
700	200				83.20	110.00	136.32			
700	500				111.64	147.92	183.72			
800	200				92.68	122.64	152.12			
800	400				111.64	147.92	183.72			
800	600					173.20	215.32			
900	300					147.92	183.72			
900	500					173.20	215.32			
900	700					198.48	246.92			
1000	400					173.20	215.32			
1000	600					198.48	246.92			

TOLERANCES

Characteristic	Tolerance
Outside dimensions, B and H	± 1.0 %, min ± 1 mm
Concavity / Convexity	Included in outside dimensions
Wall thickness, T	± 10 %
Squareness of sides	90° ± 1°
External corner profile, C1, C2	Max 3T
Length	± 5 mm
Straightness	1 mm/m
Twist	2 mm + 0.5 mm/m
External weld bead	Width: Max 2T Height: Max 2 mm

Best stainless steel solutions to answer your needs.

Over the past 45 years, we've gained the expertise, created the world's widest range of hollow sections and developed a global distribution network to be able to serve you in all corners of the globe, even in the most demanding projects and applications.

www.stalatube.com

STALA
TUBE

Head office and production:
STALATUBE OY
Taivalkatu 7
15170 Lahti FINLAND
Tel. +358 3 882 190
Fax + 358 3 882 1914
sales@stalatable.com

Stalatube Sp. z o.o.
Sosnowiec-Pieńki
ul. Przemysłowa 10
95-010 Stryków
Poland
plsales@stalatable.com

STALATUBE INC.
P.O. Box 210 Bryn Mawr
PA 19010-0210 UNITED STATES
Tel +1 610 525 7706
Fax +1 610 525 5717

STALATUBE BV
Touwslagerij 13
NL-4762 AT Zevenbergen NETHERLANDS
Tel +31 168 325 777
Fax +31 168 325 778
bvsales@stalatable.com

Stalatube India c/o SLP INOX
C- 304, Rashmi Tanmay CHS,
Eden Rose Complex, Beverly Park,
Mira Road - East, Mumbai , 401107 INDIA
Tel. +91 22 281 106 98